

**AVAILABLE SIZES**  
 - 14" x 13" X 2 9/16"

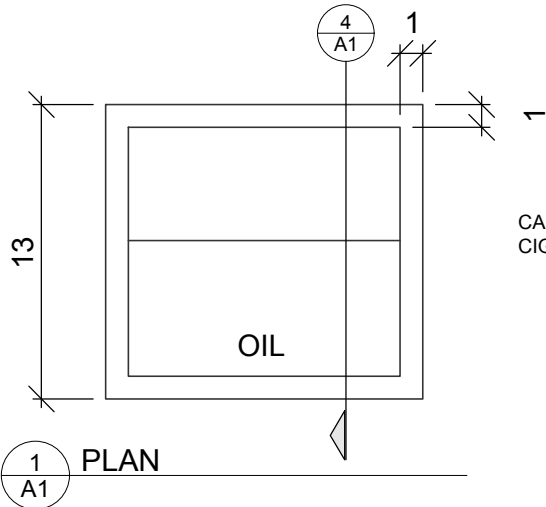

1 PLAN  
A1

CAPABLE OF PASSING A CARTON OF CIGARETTES

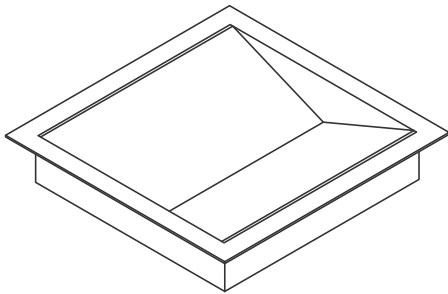

3 ISOMETRIC VIEW  
A1

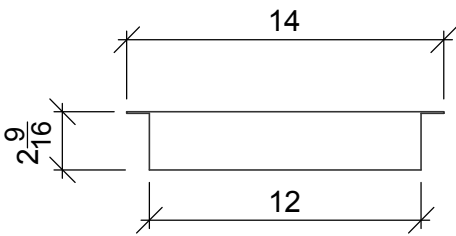

2 ELEVATION  
A1

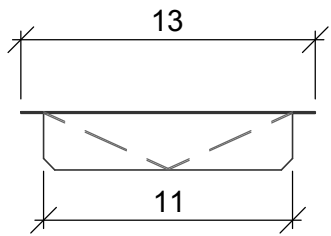

4 SECTION  
A1

INSTALL RECESSED CASH TRAY BY ROUTING OUT A HOLE IN THE COUNTERTOP (AS DETAILED)

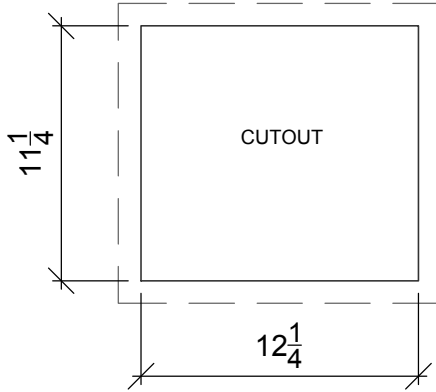

CUT OUT SIZE: 12 1/4" X 11 1/4"

PROJECT NAME: RECESSED OIL TRAY 14" x 13" x 2 9/16"		SHEET TITLE: <b>DETAILS</b>		SHEET NUMBER: <b>A1</b>	
DATE: 01.30.18		DRAWN BY: SRK		REVISIONS:	
ENG. BY:		#		DATE DESCRIPTION	
CHECKED BY:				JOB#: <b>SALES</b>	
<small>The information in this drawing is confidential. It is the property of TOTAL SECURITY SOLUTIONS. Written reproduction without the written consent of TOTAL SECURITY SOLUTIONS is prohibited.</small>					
<b>Total Security Solutions</b> 170 National Park Drive Denver, CO 80202 Phone: 517.223.7800 Fax: 517.223.0805 www.DemandTSS.com					
<b>TOTAL SECURITY SOLUTIONS</b>					